

# 4001 N. CLASSEN OFFICE BUILDING

4001 N CLASSEN BLVD, OKLAHOMA CITY, OK 73118



## OFFERING SUMMARY

Available SF:	183 - 2,232 SF
Lease Rate:	\$16 SF (Full Service)
Lot Size:	0.91 Acres
Year Built:	1973
Building Size:	16,524
Renovated:	2017
Zoning:	O2
Market:	Oklahoma City
Submarket:	North

## PROPERTY OVERVIEW

Several configurations available for lease in recently renovated and access controlled building. Great mix of long term tenants!

## LOCATION OVERVIEW

Located directly on the North West corner of 39th and Classen this property is highly visible and is just minutes from everywhere!

## AVAILABLE SPACES

SPACE	LEASE RATE	SIZE (SF)
Ste 105	\$16.00 SF/yr	2,232 SF
Ste 108	\$16.00 SF/yr	630 SF
Ste 110	\$16.00 SF/yr	183 SF
Ste 116	\$16.00 SF/yr	1,680 SF

## PROPERTY HIGHLIGHTS

- Access Control & 2 Entrances
- Abundant parking
- Highly visible building
- Available spaces perfect for individual private practice therapists or full groups.
- Recently renovated
- New Elevator & HVAC
- New paint/carpet

### JOSH WHITE, CCIM

Equity Commercial Realty II, LLC.  
josh@fleskeholding.com

(405) 701- 3505 x221 office  
(405) 417- 6761 cell  
(800) 486- 6803 fax

### ERIC C. FLESKE, CCIM

Equity Commercial Realty II, LLC.  
eric@fleskeholding.com

(405) 701- 3505 office  
(405) 990- 2509 cell  
(800) 486- 6803 fax

# 4001 N. CLASSEN OFFICE BUILDING

4001 N CLASSEN BLVD, OKLAHOMA CITY, OK 73118

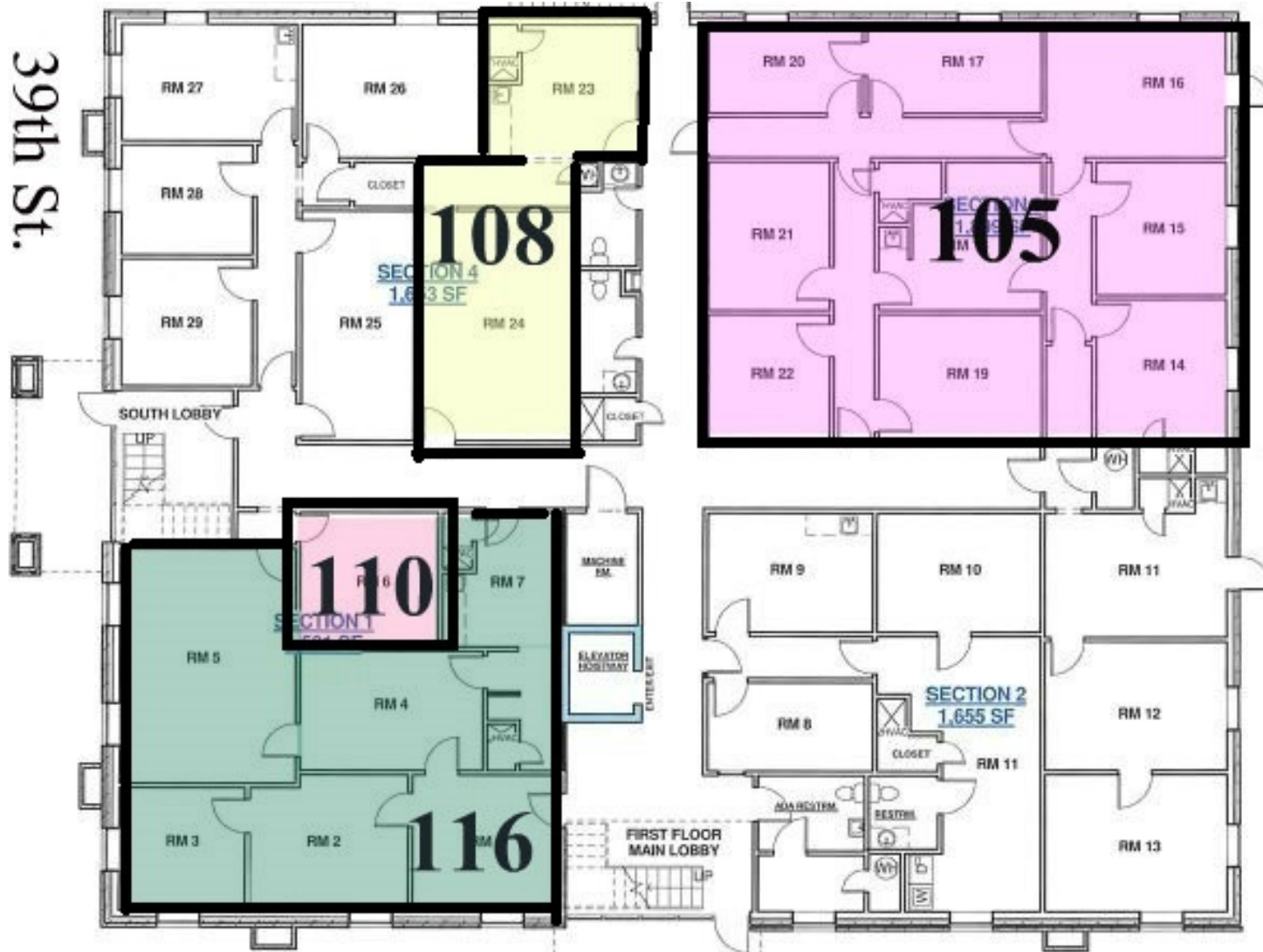

**JOSH WHITE, CCIM**

Equity Commercial Realty II, LLC.  
josh@fleskeholding.com

(405) 701- 3505 x221 office  
(405) 417- 6761 cell  
(800) 486- 6803 fax

**ERIC C. FLESKE, CCIM**

Equity Commercial Realty II, LLC.  
eric@fleskeholding.com

(405) 701- 3505 office  
(405) 990- 2509 cell  
(800) 486- 6803 fax