

RETAIL SPACE FOR LEASE

*8704 Bayberry Place, Suite 102
Louisville, KY 40242*

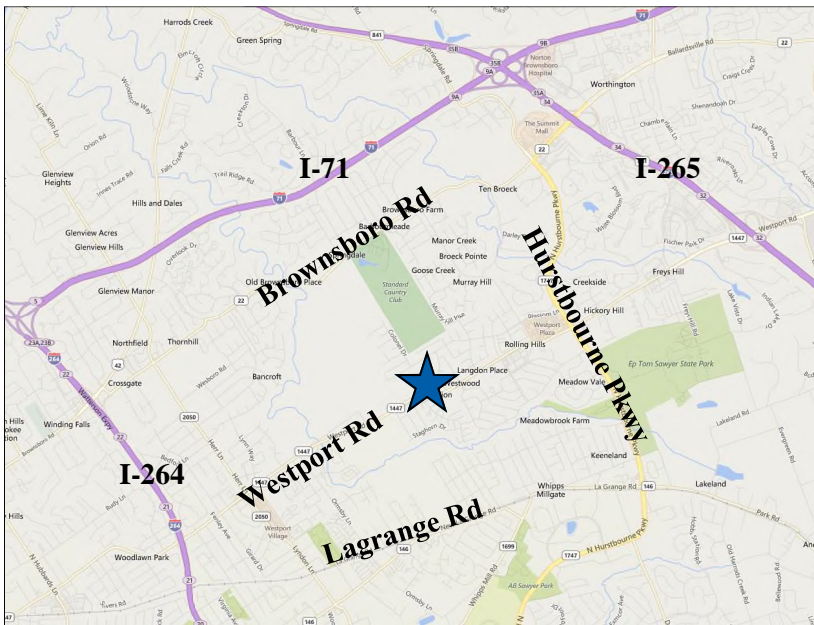

- 1,000± to 2,654± SF office/retail space
- Includes a large open area, storage room, 2 offices, 2 restrooms, rear warehouse/ storage area and drive-in door
- Ample parking
- Other tenants include dentist, veterinarian, insurance office and dog groomer
- Located just off Westport Rd in Plantation next to Louisville Indoor Racquet Club
- Zoned C-1

For Lease: \$12.00 PSF/YR, Modified Gross

Rhonda Karageorge, CCIM, SIOR
(502) 744-9175
(502) 379-6003
rk@ccre.biz



Commonwealth Commercial Real Estate, 10444 Bluegrass Parkway, Louisville, Kentucky 40299
Phone: (502) 379-6000 | www.ccre.biz | Licensed in Kentucky, Indiana and Ohio

We obtained this information from sources we believe are reliable, however, we make no guarantee, warranty or representation about it. It is provided subject to the possibility of errors, omissions, change of price, rental or other conditions, prior sale, lease or financing, or withdrawal without notice. Images or plans presented are not architectural or "as built" drawings and are presented to give an approximation of space/dimensions and, therefore, no warranty or representation, express or implied, is made to their accuracy. It is your responsibility to independently verify that the property is acceptable to you and for your intended use.

RETAIL SPACE FOR LEASE

8704 Bayberry Place, Suite 102
Louisville, KY 40242

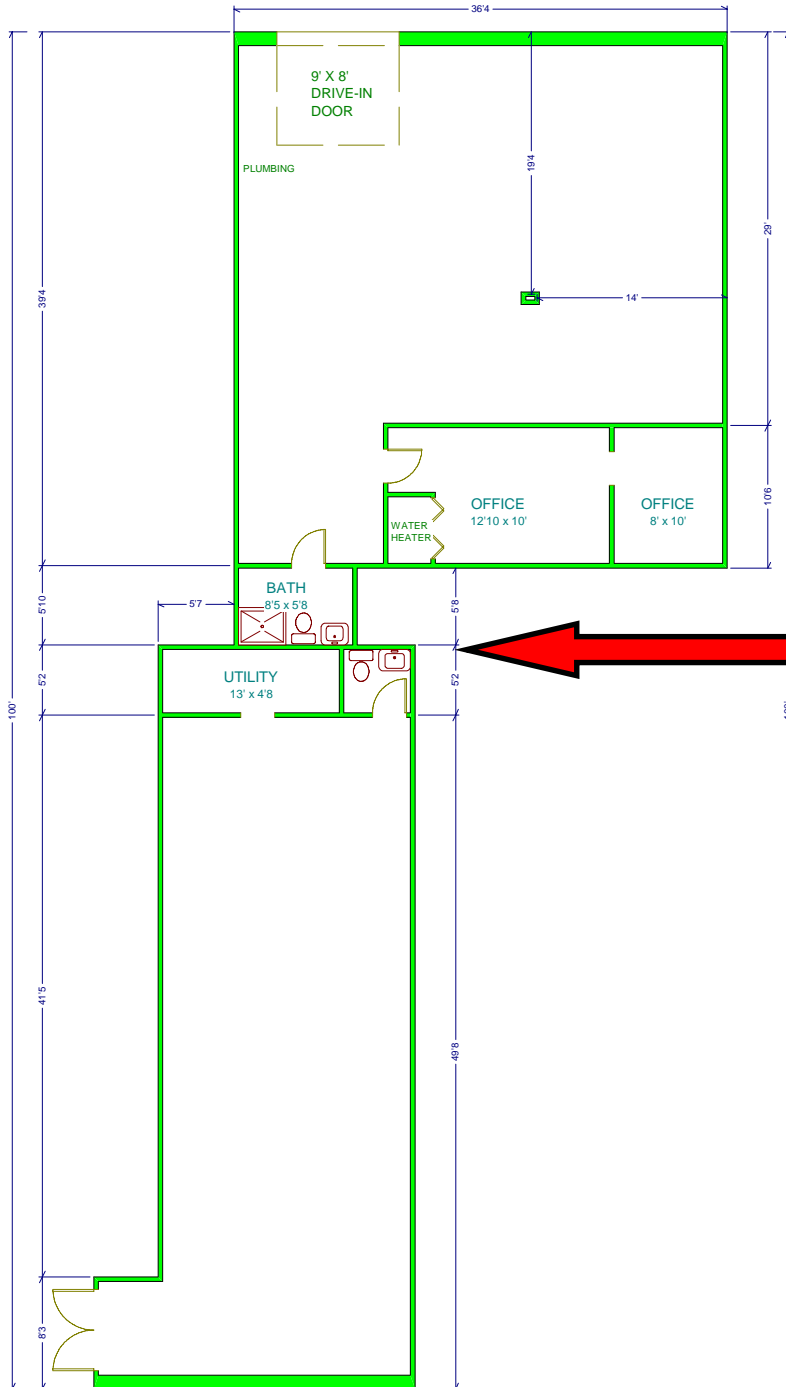
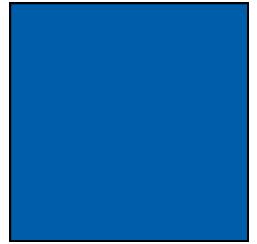

Divisible to 1,000 SF
and 1,564 SF

Commonwealth Commercial Real Estate, 10444 Bluegrass Parkway, Louisville, Kentucky 40299

Phone: (502) 379-6000 | www.ccre.biz | Licensed in Kentucky, Indiana and Ohio

We obtained this information from sources we believe are reliable, however, we make no guarantee, warranty or representation about it. It is provided subject to the possibility of errors, omissions, change of price, rental or other conditions, prior sale, lease or financing, or withdrawal without notice. Images or plans presented are not architectural or "as built" drawings and are presented to give an approximation of space/dimensions and, therefore, no warranty or representation, express or implied, is made to their accuracy. It is your responsibility to independently verify that the property is acceptable to you and for your intended use.