

29153 GROESBECK HWY.  
ROSEVILLE, MICHIGAN

INDUSTRIAL FOR LEASE  
18,600-22,600 Square Feet Available



**SIGNATURE  
ASSOCIATES**  
KNOW SIGNATURE | KNOW RESULTS

**RECENTLY RENOVATED**



## PROPERTY FEATURES

- 18,600 – 22,600 square feet available
- 2,000 square feet of office
- 20' – 23' clear height
- (8) 12x14, 14x16 grade level doors
- 2-3 Ton bridge cranes – footings for heavier
- Zoned I-2
- Heavy power distributed throughout with upgrade switch gear
- Heavy steel mezzanine
- Close proximity to I-696, GM Tech Center, the defense corridor and auto plants
- Lease Rate: \$5.00/sq.ft. NNN



For more information, please contact:

**BEN WILKEMEYER**  
(248) 359 0624  
bwilkiemeyer@signatureassociates.com

**PAUL SAAD**  
(248) 359 0652  
psaad@signatureassociates.com

**SIGNATURE ASSOCIATES**  
One Towne Square, Suite 1200  
Southfield, MI 48076  
www.signatureassociates.com

# 29153 Groesbeck Hwy. – Roseville, Michigan

## Industrial For Lease

18,600–22,600  
Square Feet  
AVAILABLE

### Additional Photos



For more information, please contact:

**BEN WILKEMEYER**

(248) 359 0624

[bwilkiemeyer@signatureassociates.com](mailto:bwilkiemeyer@signatureassociates.com)

**PAUL SAAD**

(248) 359 0652

[psaad@signatureassociates.com](mailto:psaad@signatureassociates.com)

**SIGNATURE ASSOCIATES**

One Towne Square, Suite 1200

Southfield, MI 48076

[www.signatureassociates.com](http://www.signatureassociates.com)

Information is subject to verification and no liability for errors or omissions is assumed. Price is subject to change and listing withdrawal.



29153 Groesbeck Hwy. – Roseville, Michigan  
Industrial For Lease

18,600–22,600  
Square Feet  
AVAILABLE

Site Plan

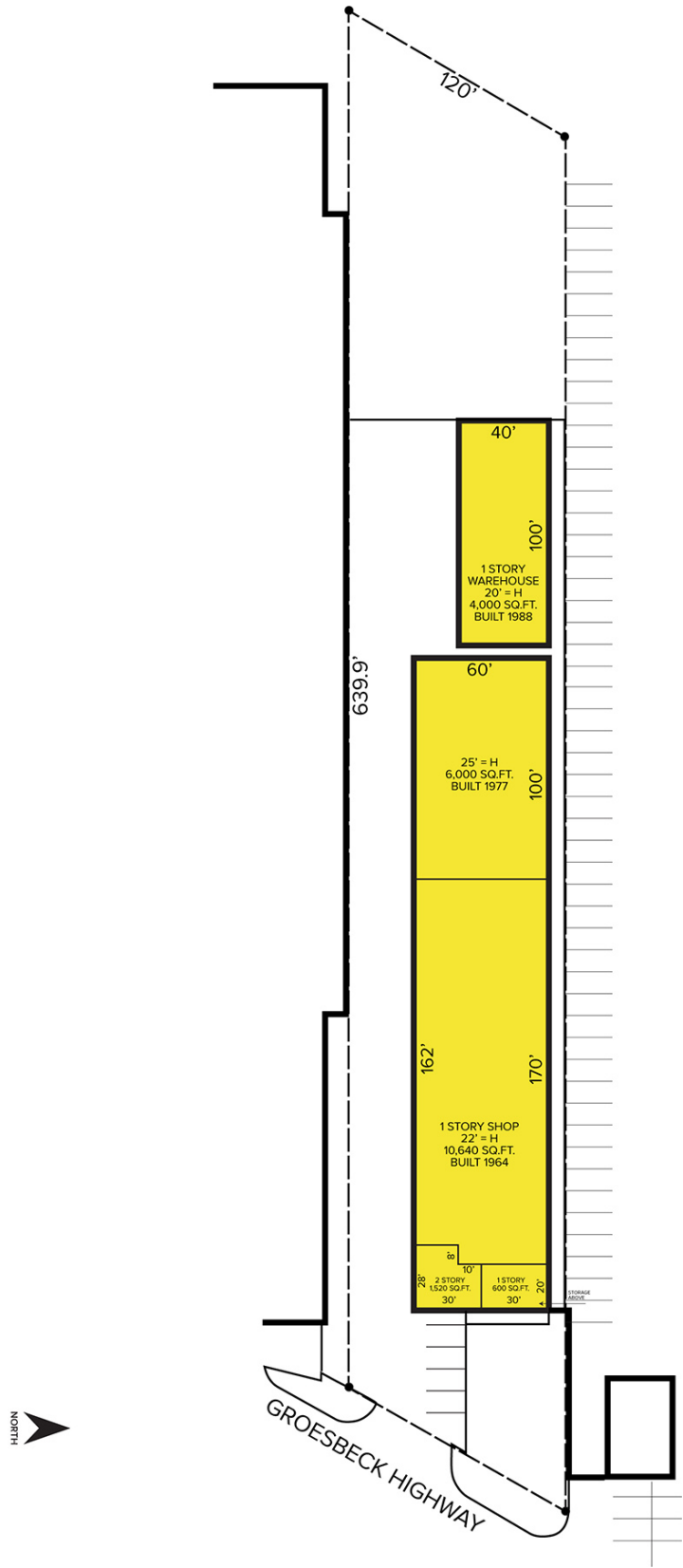

For more information, please contact:

**BEN WILKEMEYER**  
(248) 359 0624  
bwilkiemeyer@signatureassociates.com

**PAUL SAAD**  
(248) 359 0652  
psaad@signatureassociates.com

**SIGNATURE ASSOCIATES**  
One Towne Square, Suite 1200  
Southfield, MI 48076  
www.signatureassociates.com

Information is subject to verification and no liability for errors or omissions is assumed. Price is subject to change and listing withdrawal.

29153 Groesbeck Hwy. – Roseville, Michigan  
Industrial For Lease

18,600–22,600  
Square Feet  
AVAILABLE

Floor Plan

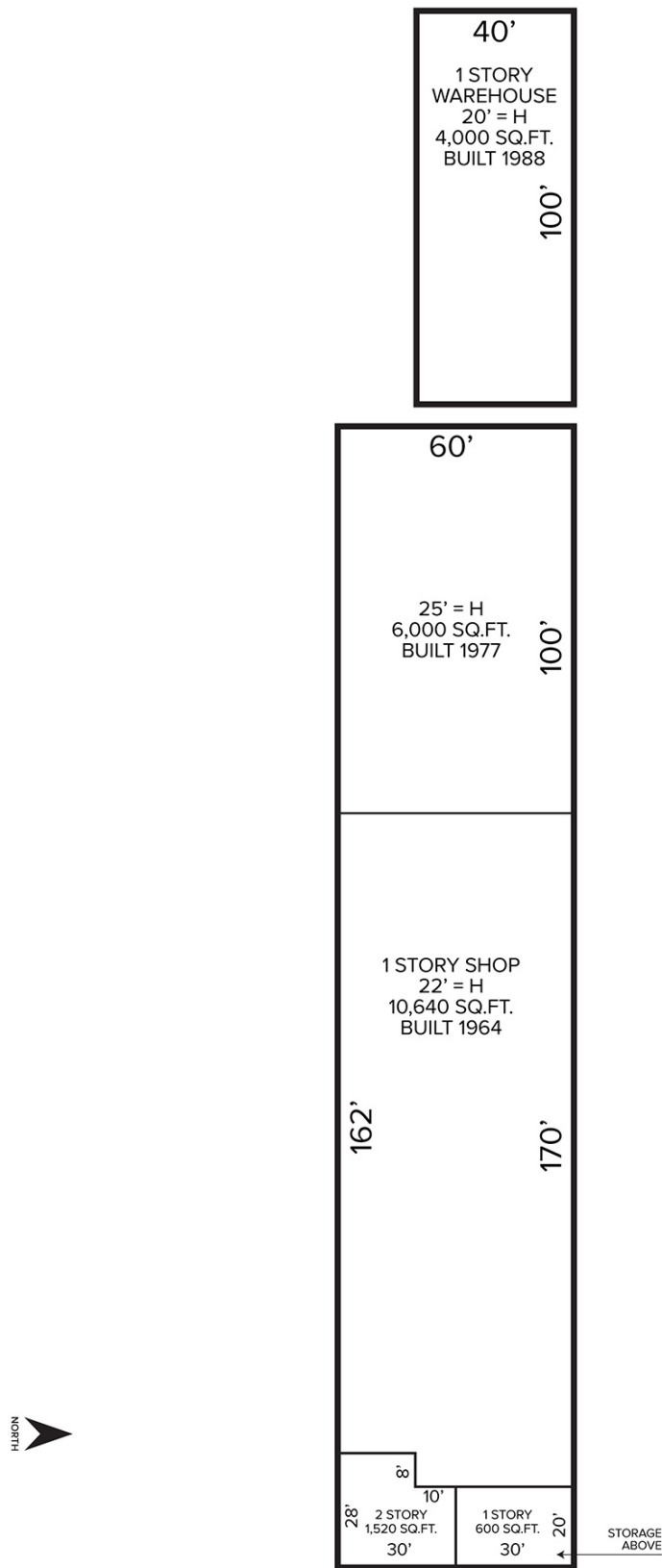

For more information, please contact:

**BEN WILKEMEYER**  
(248) 359 0624  
bwilkiemeyer@signatureassociates.com

**PAUL SAAD**  
(248) 359 0652  
psaad@signatureassociates.com

**SIGNATURE ASSOCIATES**  
One Towne Square, Suite 1200  
Southfield, MI 48076  
www.signatureassociates.com